

## The Last Degas Valve You Will Ever Buy



The Telchine family of degas valves are designed from the ground up for long term mission critical use in ozone applications. A degas valve is typically placed on top of an ozone contact tank to vent excess ozone and air from the

tank. The valve closes automatically in the presence of water and allows the tank to hold pressure. Nearly all degas valves use a simple float and lever design but cannot endure exposure to ozone and fail prematurely, sometimes in weeks or months. This failure causes unnecessary downtime, and costly repairs if water passes downstream to catalyst destructs and other equipment. The TE-DGV and TE-CDGV are designed using only ozone compatible materials, while also allowing easy disassembly if cleaning or replacement is ever required.



## FEATURES

- Designed with only ozone compatible materials to prevent chemical attack and premature wear.
- Integrated inlet diffuser for optimal gas/liquid separation.
- Integrated clear sight glass to inspect process and valve condition.
- Single and dual valve units available for high-flow requirements, or for redundant operation.
- NPT threaded connections for inlet and outlet can be adapted for a variety of connection styles and sizes.
- Tall Unit (TE-DGV) and Compact unit (TE-CDGV) available to suit flexible performance and installation requirements.

## SPECIFICATIONS

Model No	TE-DGV01	TE-CDGV01	TE-DGV02	TE-CDGV02
Inlet Connection	1 in NPT			
Outlet Connection	½ in NPT	(qty 2) ½ in NPT		
Design Pressure	50 psi			

## FLOW RATE CHARTS

We recommend choosing a flow rate that is 70% or less of the maximum flow rate. Higher flow rates may not allow complete off-gassing of ozone.

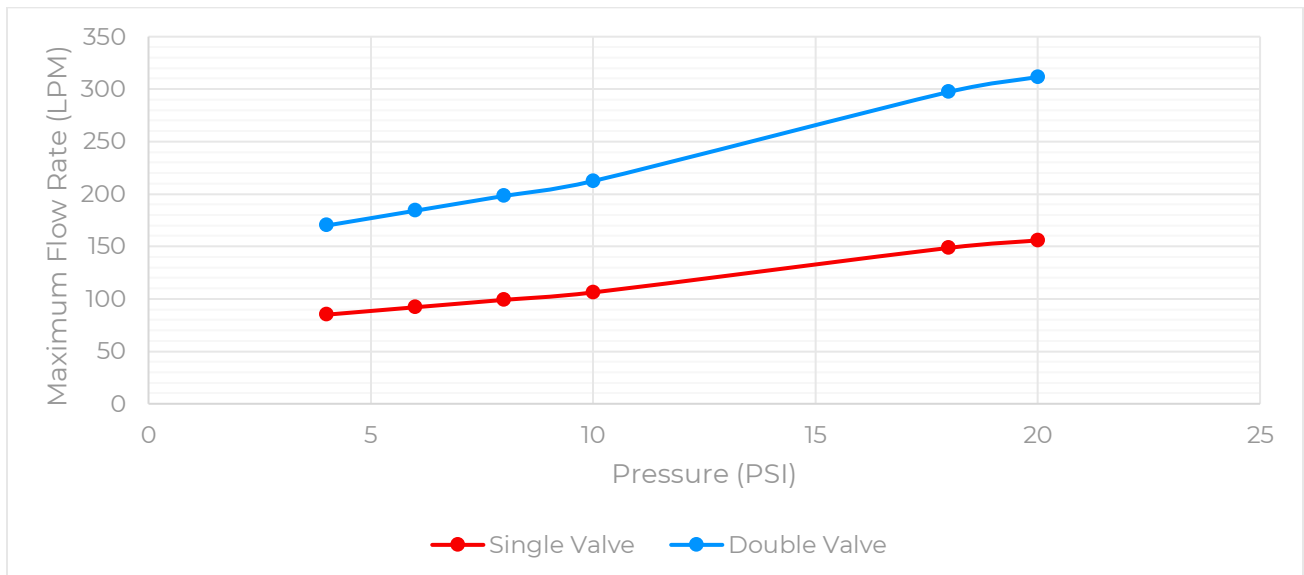
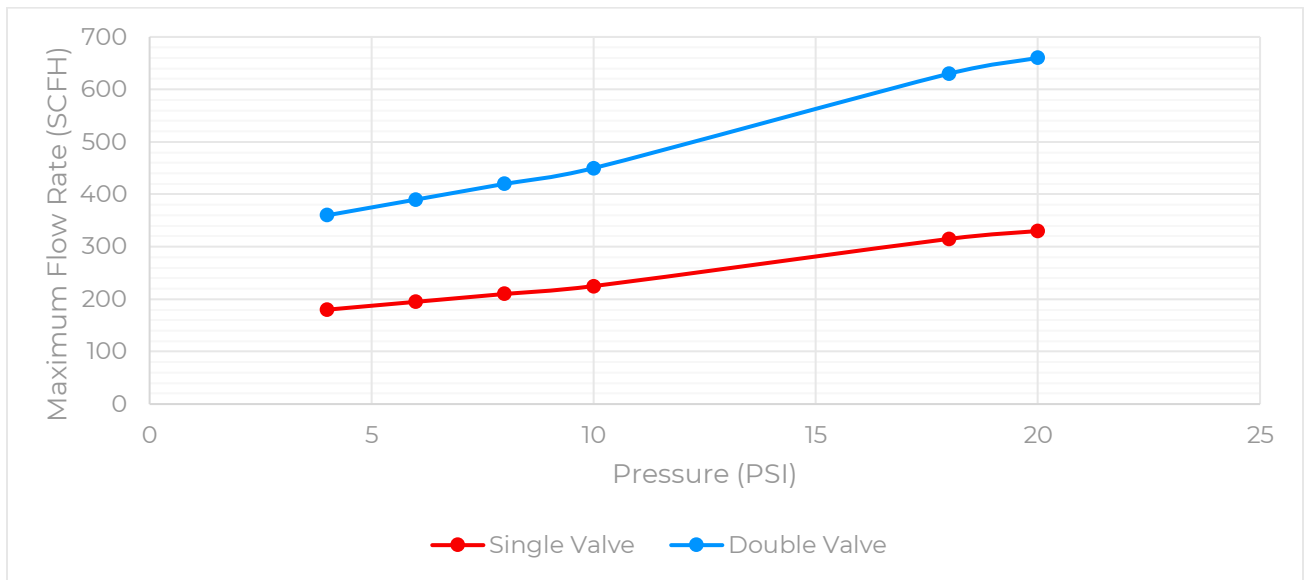

## DIMENSIONS

**Compact Degas Valve  
(TE-DGV)**

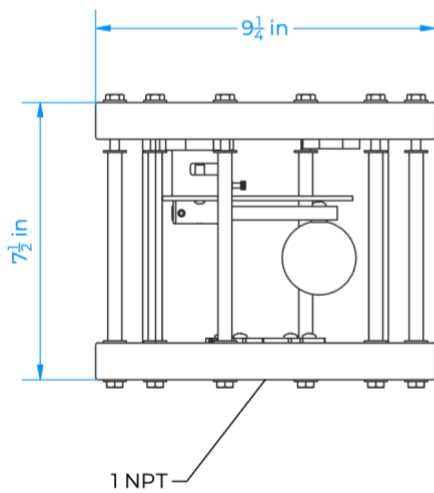
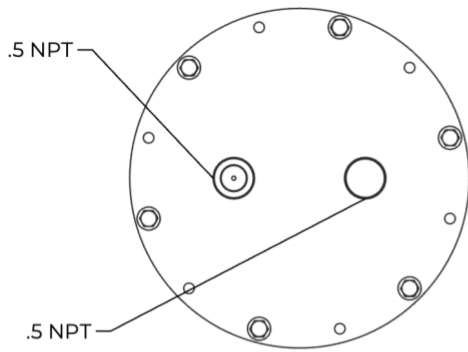

NOTE: ON SINGLE FLOAT MODELS  
ONE OF THE HOLES IS PLUGGED UP.

**Tall Degas Valve  
(TE-DGV)**

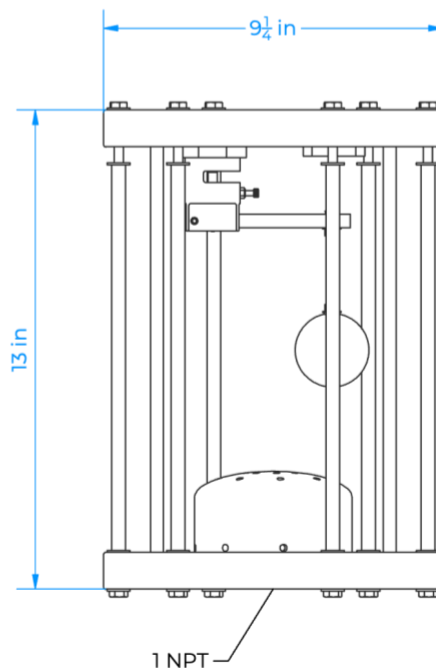
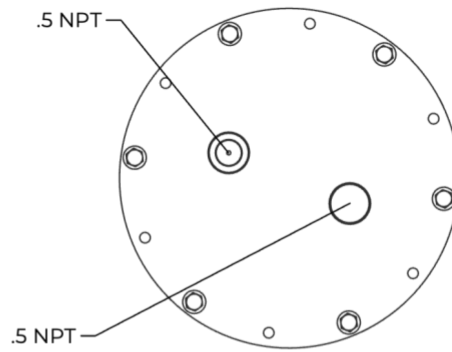

## Chemical Resistance Compatibility for Materials

	Material	Ozone Compatibility
<b>CPVC</b>	Valve housing, lever, flanges	A – Excellent
<b>Borosilicate Glass</b>	Housing glass	A** - Excellent
<b>Stainless Steel AISI 316</b>	All hardware, valve float.	A – Excellent
<b>Aflas®</b>	Internal O-Ring	A* – Excellent
<b>PVDF</b>	Valve Pin	A – Excellent

*Material Compatibility established by Cole-Parmer® Chemical compatibility database.*

*\* Aflas® compatibility established by Val-Matic® Chemical Resistance Guide*

*\*\* Glass compatibility established by De Dietrich Process Systems® Chemical Resistance Guide*

## SPARE PARTS

The Telchine degas valve is designed for years of trouble-free operation. However, certain circumstances may require a rebuild of the degas valve unit. We sell spare parts kits for all consumable parts including gaskets, O-rings, and connectors. The kit includes instructions for installation and calibration.

DGV01-11911	Service Kit for TE-DGV01 or TE-CDGV01
DGV02-11911	Service Kit for TE-DGV02 or TE-CDGV02

To order a kit, submit a service ticket to [info@telchine-rd.com](mailto:info@telchine-rd.com)